

If you encounter errors, call the service desk and provide them with this information:

- Identify yourself and advise them that this is for a **Telestroke Urgent Clinical Consultation**.
- Provide your location and the VCU # (found on the sticker on the monitor and/or equipment).

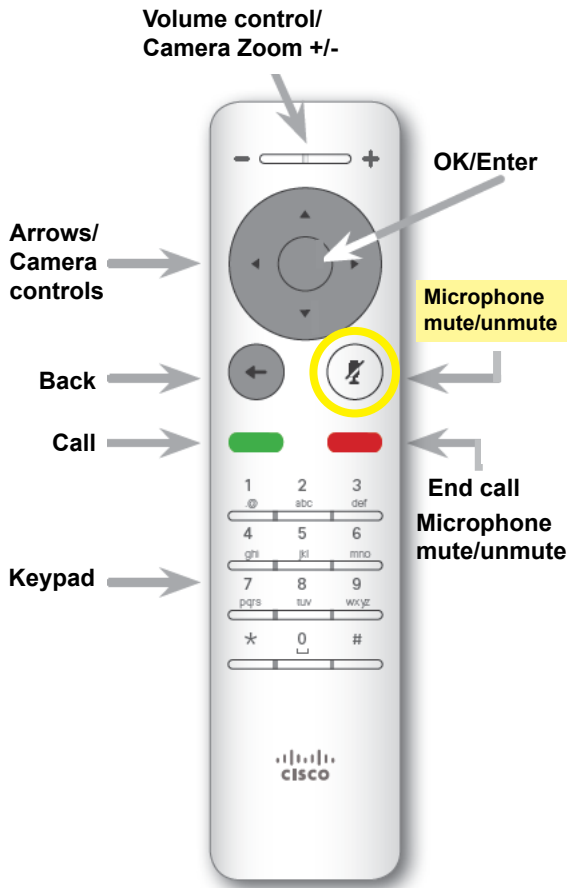

#### Adjust the Camera

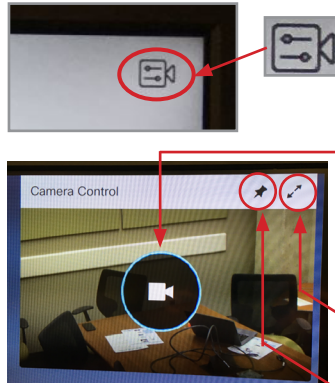

- Pick up the remote and press the Back button to wake up the system.
  - Arrow over to the Camera icon in the top right corner and press OK on the remote.
  - Press OK on the camera icon and adjust as necessary to ensure you are visible so the far end site will see you.
  - Press the Back button twice to back out of the camera menu before placing a call.
- Maximize/minimize Selfview
- Show/hide Selfview

#### Make the Call

- Press the green **Call** button on the remote.
- Ensure the **Favourites** tab is selected and use the arrows on the remote to scroll down and select the site.
- Press the green **Call** button to place the call.
- Press the **Microphone** key to unmute and ensure other site can hear you.
- Verbally direct the staff at the patient site to assist with moving the camera and/or patient throughout the session.
- Press the red End Call button on the remote to disconnect at the end of every call.

#### Take control of the other site's camera (far end control)

- Navigate to the **Participants** icon at the top of the screen.
- Press **OK**, scroll down to select the site and press **OK** again.
- Arrow over to the **Camera** icon and press **OK**.
- Select **Camera** and move the camera as required.
- Press the **Back** button to exit and regain control of your own camera.

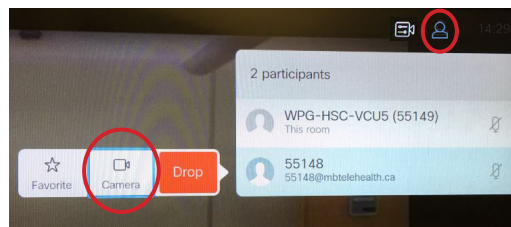

**You can connect using the 5 digit number in the chart below instead of using Favourites.**

1. Enter the 5 digit number for the site you need to connect to using the keypad on the remote.
2. Press the green Call button on the remote to place the call.

Telestroke Site	5 digits
Brandon Telestroke-VCU8	56022
Dauphin Telestroke-VCU7	56071
The Pas Telestroke (ER)-VCU4	56038
The Pas Telestroke (SCU)-VCU5	56039
Thompson Telestroke-VCU9	56348